



Thank you for
renting our
camper!

We hope you
enjoy it as much
as we do on our
adventures!

The Babb Family

THE TREKKER

2015 Summerland

1. EMERGENCY CONTACTS

IN CASE OF EMERGENCY DIAL 9-1-1

OWNER: Chris Babb – 228-731-4075

Kelly Babb – 601-514-5230

RV Share – 1-888-482-0234

24/7 Emergency Roadside Assistance – 1-844-964-6249

**SMOKING IS STRICTLY PROHIBITED IN THIS TRAILER.
SMOKING IN THIS TRAILER WILL RESULT IN THE FULL
FORFEITURE OF ALL SECURITY DEPOSITS AND MAY
WARRANT ADDITIONAL FEES**

No Refunds for Early Returns: If you return early, we do not refund the days you will not use. This includes if you have an accident or crash in the unit, however if the crash is not your fault you may be able to recover your rental costs from the at-fault driver's liability insurance.

Fee for Late Returns: If you are late returning the unit there is a \$40 per hour late fee. You will also be responsible for the cost of any canceled rentals due to your late return.

All drivers must be at least 30 years old and must be listed on the contract when you pick up the unit. NO EXCEPTIONS.

NO DRUGS: Any evidence of the storage, transportation, or use of illegal substances will forfeit your entire security deposit. RVs returned with any evidence of drug use or transportation will result in law enforcement being called for a report and to collect the evidence.

Travel Restrictions: Our RV unit is NOT allowed to travel into Mexico & our insurance does not cover you or the unit in Mexico. No travel allowed on any non-paved roadways like logging roads, forest service roads, beaches, etc.

Toll Roads, Red Light Cameras, Parking Tickets, etc: Parking Tickets, Mailed Violations, and Toll invoices are a major burden and we charge a \$75 fee for each invoice we get.

Responsibility for traffic or parking violations will be transferred to you and you will be charged a \$75 administration fee. If you want to use Toll Roads, you are free to pay at the plazas or bring your own toll tags, just make sure no invoices or toll by plate, etc mail comes our way or the \$75 administration fee will apply!

***Note:** Most toll agencies are good to work with and will help you out if a mistake and call them right away.*

Pets: We allow small dogs in some of our units, but an extra cleaning fee applies. You must have prior authorization from us also. Many renters are allergic to pets so we must charge extra because it takes a lot of work to clean the RV after a pet has been in it to remove all the pet hair, dander, and sanitize every surface. Our current small dog fee is only \$50 for the entire rental period and applies only to those units that have been classified as pet friendly. You are 100% responsible for any damage cause by the pet. Lack of authorization will result in you losing your security deposit.

2. 2015 SUMMERLAND SPECS

DRY WEIGHT 5,840lbs. GVWR (gross vehicle weight rating) 7,645 lbs

TOTAL LENGTH 29.8 ft

HEIGHT 10.5 ft

HITCH SPECS 2 5/16" ball hitch

HITCH WEIGHT 645lbs

WATER TANK CAPACITY 55 gallons

GREY WATER TANK CAPACITY 42 gallons

BLACK WATER TANK CAPACITY 32 gallons

3. DRIVING WITH A TRAVEL TRAILER

Do not exceed 65 MPH. Relax, take your time, you're on vacation.

Give yourself plenty of time and space when stopping, never slam on the brakes and remember, you need extra room when turning a trailer when making right turns.

Be aware of trailer sway. A few factors can cause the trailer to sway and fishtail – excessive speed, cross winds, draft from passing tractor trailers, and an unbalanced load inside the trailer (i.e. don't pack all your gear on one side). The best way to correct trailer sway is to avoid it in the first place - avoid travel during heavy crosswind weather and be aware of large trucks coming up from the rear to counter-steer their bow wave drafts. If your trailer starts to sway on

the road, the NHTSA recommends activating the manual brake control override by hand. Applying the tow vehicle brakes will generally make the sway worse. Lift your foot from the accelerator but don't step on the brake pedal unless you're in danger of hitting something. <https://blog.nationwide.com/rv-towing-tips-for-preventing-trailer-sway/>

The trailer is not to be driven on any unpaved roads except those in licensed RV parks and campgrounds or maintained municipal roads. DO NOT drive on unmaintained roads, logging roads, forest service roads, beaches, etc.

4. INITIAL SET UP OF TRAILER

A. UNHOOKING TRAILER AND STABILIZING TRAILER

1. DO NOT BACK UP VEHICLE WITH SWAY BARS ATTACHED!!!
2. Once you have the camper in your selected spot...
3. Place chock blocks at tires.
4. Disconnect cotter pins, sway bars, sway support bars, electric cable, safety brake cable, tow chains and unlock hitch. Replace cotter pins on bars so they don't get lost.
5. Place two yellow blocks (located in front storage compartment) under jack. Extend electric jack. Be sure to raise jack high enough to clear ball on hitch.
6. Move vehicle forward.
7. Place provided level (located on the floor at the foot of Master Bed) on floor in doorway and lower tongue jack till level.



8. Place yellow blocks under all four stabilizer jacks and lower jacks using metal crank in front storage compartment. Lower them until they are on the blocks. Warning: The stabilizer jacks are NOT designed to level or elevate the trailer.
9. Check for side to side level and adjust stabilizers accordingly using blocks.



B. SETTING UP UTILITIES

1. **ELECTRICITY**- Make sure 30amp breaker is off at the power pedestal. Pull 30amp cord out of trailer and plug into the surge protector (located in the rear compartment) and then connect to the 30amp power source. Cord is located on the back of the trailer. **DO NOT PLUG INTO A NORMAL OUTLET.** When all connections are made turn the 30 amp breaker at the pedestal on.



POWER CORD



Surge Protector

2. **WATER HOOKUP**- Connect the blue hose and water filter to the city water connection located at the front of the trailer. A pressure regulator is attached to the hose. **DO NOT REMOVE PRESSURE REGULATOR FROM HOSE.**



WATER



**Pressure
Regulator**

Water Filter

3. **SEWER CONNECTION-** Using the provided sewer hose located inside rear storage compartment, connect it to the sewer coupling located on the right side of the trailer (look for sewer outlet connection sticker). Connect by twisting the end of the hose to the coupling on the trailer.
 - a. Place L shaped coupler into the campsite sewer drain
 - b. Place black hose stabilizer under sewer hose. Ensure the hose is walked out and in a downward position so waste can flow into the sewer drain.
 - c. There is also a flush coupler included with the hose. Place the flush coupler directly on the camper outlet and then connect the drain hose to the flush coupler.

4. **SLIDE-** Slide switch is located just inside the main living room door. Extend slide all the way out.

***MAKE SURE THERE ARE NO OBSTRUCTIONS TO THE AREA THAT THE SLIDE WILL GO OUT.

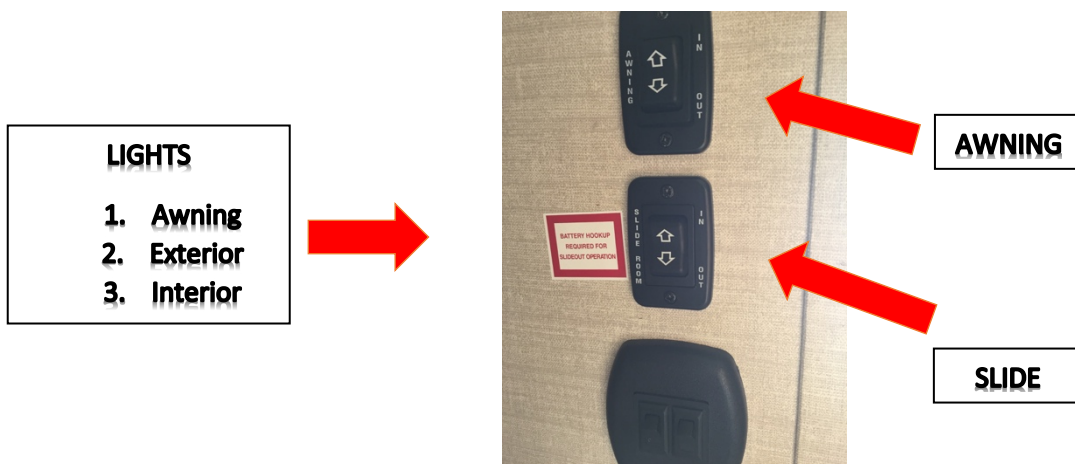



5. WATER HEATER- Turn on water heater. Panel is located in kitchen.

6. REFRIGERATOR- Turn on refrigerator using buttons on top of refrigerator. Make sure the light for AUTO is lit up.



7. HEAT/AIR

a. HEAT- The thermostat is located on the partition wall as you enter the camper. Heat is run by propane. Ensure propane valve on tanks located at the front of the trailer is open. Set to desired temperature.

b. Located under the couch, is an electric heater. It is suggested for you to use the electric heater. The electric heater keeps the camper at a more even temperature than using just the gas. We generally only use the propane heater when it is freezing. We will set the propane to a lower temp so that it only kicks on when if the electric cannot keep up.

c. Air conditioning: A/C controls are located in the ceiling on the unit itself over the kitchen area. Make sure that each setting clicks into place. Do not set controls in between settings. A/C should only be run if on full power hook ups. DO NOT RUN WHEN IT IS NOT



A/C



Heat

PLUGGED IN. Choose between low fan, high fan, low cool or high cool and set to desired temperature. Do not keep it on the coldest setting for too long or the unit could possibly freeze up.

8. AWNING- The awning switch is located beside the slide switch (see above picture in slide section). DO NOT OVEREXTEND. The awning should come out till flap falls down. It is recommended to roll the awning up when you are not at the camper.

*****The awning IS NOT covered by insurance. Any damage to the awning will be 100% your responsibility. This will result in forfeiting your deposit and additional charges to cover the cost of the damage, which is typically around \$3,000 to repair. Due to the cost, I discourage the use of the awning for your protection. If you do decide to use, it is recommended you retract the awning anytime you leave your campsite, go to sleep, or when rain, winds, or bad weather is forecasted. Damage to awnings, including damage while driving, (tree, toll road, etc.) are 100% your responsibility and will exceed your security/damage deposit amount.**

Please refer back to the rental rules and agreement for further information***

ENJOY! YOU ARE NOW READY TO CAMP!

5. STAYING IN TRAILER

1. GAS COOK TOP Ensure the propane tank is in the ON position.
 - a. Turn a cook top to LITE position and listen for the gas supply.
 - b. Use a lighter, located above the stove to light the gas.
2. OVEN- Ensure the propane tank is in the ON position.



on the bottom. We usually set the temp a little lower than normal or take the food out a little sooner.

- a. Open oven door, turn oven knob to pilot on, and push and hold oven knob in to release propane.
- b. Ignite pilot light with long lighter (in cabinet above stove).
- c. Once pilot is lit, set the knob to the desired temp. The oven has a tendency to burn the food

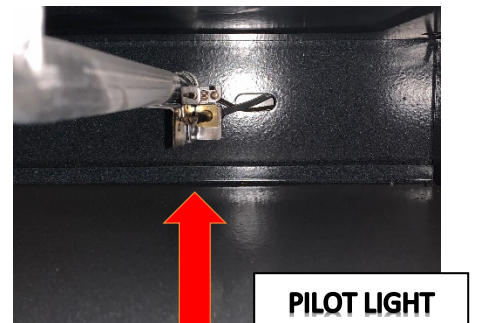

3. **BLACK AND GREY WATER DUMPING-** The black and grey water control panel is located in the kitchen. Tank levels need to be monitored daily. Press the black button for the black water tank and the grey button for the grey water tank. When pressed, the light will illuminate to show the level the tank is at. So, if the level is at 1/3 full the light over 1/3 will illuminate. Dump tanks once they the level reaches 2/3 or full. *****MONITOR LEVELS. IF SYSTEM OVERFILLS IT WILL BACK UP INTO TRAILER*****

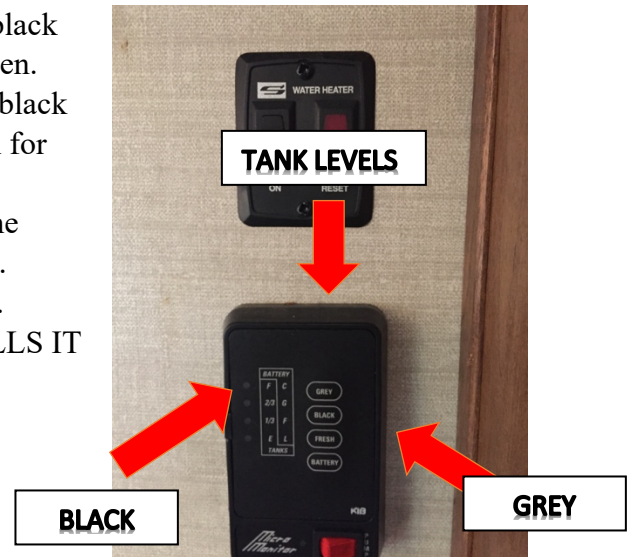

- a. Grey water: grey water is water from the sinks and shower. Grey water can be dumped every other day; however, if a lot of water is used, it will need to be dumped daily. I recommend always checking levels before showering. Showers can fill the tank fast. Grey tank water valve can be left open until the next to last day. It will need to be closed this day to fill up the tank to help with the final cleaning.
 - b. Black water: black water is from the toilet. It can be dumped every 2-3 days. **MONITOR LEVELS**
 - c. Dumping tanks: the dumping levers are located by the sewage connection on the right side of the trailer. The LEFT lever is for grey water and the RIGHT is for black water.
 - d. If dumping both tanks, dump the black water tank first. Then follow with grey water. This will help clean the sewage hose.
4. **TOILET:** DO NOT put anything except the provided RV safe toilet paper in the toilet. Dispose of tissues, feminine products, etc. in the garbage can. We provide toilet paper, but if you run out YOU MUST purchase RV safe toilet paper. If you are near a Walmart, it is located in the camping section.
- a. To flush the toilet, use the foot pedal. Push halfway to fill bowl with water, push all the way to open the hole and flush.
 - b. Always fill the bowl about halfway with water. This helps keep the black water tank full so the sewage will dump easier and won't get stuck on the sensors.

5. **SHOWER** When showering, open the vent above the shower and turn the fan on. This helps ensure the bathroom does not get moldy and dries out. The shower head is equipped with a “sea shower” function to help reduce water usage and filling tanks fast. Press the button while in the shower. Then press the other way to have full power.



6. TV Remotes are located on the wall inside the TV cubby or beside the Master Bed.

a. Antennae: the antennae is located on the ceiling near the bunk beds. Turn the dial to raise. This must be lowered before you hook up the camper. If you drive with it up, will cause damage and you will be 100% responsible for all damages.

7. **STEREO** The stereo plays both inside and outside the trailer. To adjust the speakers from inside to out go to the sound settings and turn from left to right speakers.

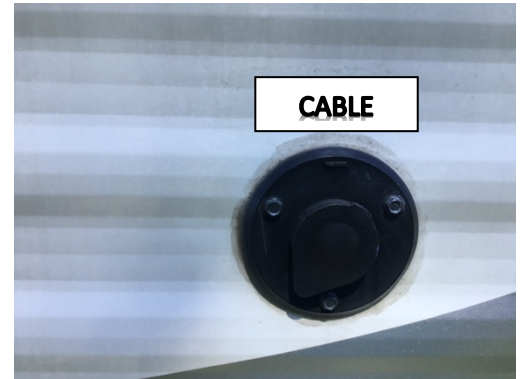

8. **FUSE PANEL** Fuse panel is located under the kitchen drawers. If a fuse trips, push on the panel (upper center) and open it up. Check for the tripped fuse and reset to the right. Do not use too many appliances at once this will trip fuses.



6. CAMPING ACCESSORIES

Accessories Located in Front Storage

Five camp chairs and large mat are located in the front storage compartment.

- Please sweep and roll up the turf mats after use
- Please keep the camp chairs far from campfire so they do not get damaged
- Outdoor Trash Can (Use a garbage bag for easy cleanup.)
- Spray out and dry trash cans prior to return (only spray if they get soiled).

Accessories Located in Cabinets Above Couch

- Plates, bowls, cups, grilling utensils.

Accessories Located under Table

- Pots and Pans on side nearest the couch.
- Extra sheets and pillows on side nearest the bathroom.

Accessories Located Under Couch

- Extra Blankets
- Small Vacuum
- Board Games

Cabinet and Drawers Under Bar

- Bath Towels, Bath Washcloths, Flashlights

7. DISCONNECTING CAMPER

1. Turn off A/C and water heater.
2. Retract awning if out.
3. Close shower vent and turn off if open or on.
4. Lower cable antennae.
5. Turn propane off (if using).
6. Flush black water and grey water tanks.
 - a. Following dumping instructions as stated above. Black first, then gray.
 - b. Disconnect city water hose from trailer and connect hose to flush coupler on sewer hose.
 - i. Turn water on and flush tank for at least 10 min. **MAKE SURE BLACK WATER RELEASE IS IN OPEN POSITION.**
 - c. Shut water off, disconnect hose, disconnect couplers, and sewer hose. Rinse sewer hose and store all sewer items in sewer basket in rear storage compartment. Store all water lines in hose basket.
 - d. Drain all water from the freshwater tank by flipping the valve located in the center front underneath the camper.
7. Using stabilizer jack tool raise stabilizer jacks and remove plastic pads if used. Store pads in rear storage.
8. Raise tongue jack so it is above hitch on vehicle.
9. Align vehicle hitch with trailer hitch and lower tongue jack onto the ball. Lock hitch onto ball.
10. Fully retract tongue jack.
11. Unhook electrical cord and stow.
12. Remove and store chock blocks.
13. Check to make sure brake lights and turn signals work.
14. Adjust trailer brakes with controller in vehicle.
15. Walk around the camper and the campsite to make sure everything is Clean

Have a safe trip home!

8. ELECTION OF TOW, SET UP, AND PICK UP

If you elected for me to tow the trailer, set up, and pick up you do not need to worry about setting the camper up. We will have the camper ready for use. However, please read the below requirements you are responsible for.

1. SET UP We will set up the trailer and have it ready for use. The only items you need to worry about are the camping accessories. If you wish to use them, you can set them up.
2. PICK UP The below items are what you will be responsible for prior to pick up.
 - a. Turn off A/C and water heater.
 - b. Retract awning if out.
 - c. Close shower vent and turn fan off, if open or on.
 - d. Lower cable antennae.
 - e. Turn propane off (if using).
 - f. Flush black water and grey water tanks.
 - i. Following dumping instructions as stated above. Black first, then gray.
 - ii. Disconnect city water hose from trailer and connect hose to flush coupler on the sewer hose.
 1. Turn water on and flush tank for at least 10 min. **MAKE SURE BLACK WATER RELEASE IS IN OPEN POSITION.**
 2. Leave gray water and black water valves open.
 - g. Stow all camping accessories used.
 - h. Clean according to cleaning checklist.
 - i. Do not worry about disconnecting the power, water lines, or sewage lines.

9. RETURN CLEANING CHECKLIST

THE TRAILER IS REQUIRED TO BE RETURNED IN THE SAME CONDITION AS IT WAS AT TIME OF RENTAL PICK-UP

Additional charges will be assessed to renter if extra cleaning is required after the trailer is returned. Charges will be deducted from your security deposit.

- ☐ Remove all personal belongings and leftover food items.
- ☐ Wipe out the fridge and freezer.
- ☐ Wipe out pantry.
- ☐ Make sure all kitchenware, appliances, and dishes are washed, dried, and put away.
- ☐ Clean out microwave, stove top, and sinks.
- ☐ Wipe down all countertops, table, couch, and seats.
- ☐ Clean toilet and shower (ONLY use dish soap to clean shower).
- ☐ Remove and dispose of all trash. (Check campground rules for where to put garbage.)
- ☐ Vacuum and sweep out trailer (vacuum located under the couch and broom is located at the foot of the master bed).
- ☐ Remove all personal belongings from interior/exterior storage areas.
- ☐ Put all soiled linens and towels in bathtub.

IT IS MY GOAL TO RELEASE YOUR ENTIRE SECURITY DEPOSIT TO YOU.
PLEASE MAKE SURE TO TAKE CARE OF THE TREKKER AS IF IT WERE YOUR
OWN SO THAT WE CAN ACCOMPLISH THIS.

I WOULD BE HONORED IF YOU WOULD TAKE THE TIME AFTER YOUR TRIP TO
WRITE A 5 STAR REVIEW SO OTHERS CAN SEE WHAT TO EXPECT IF THEY
SHARE OUR TRAILER. YOUR REVIEW MAKES A HUGE DIFFERENCE FOR THE
RV SHARE COMMUNITY AND FOR MY BUSINESS. THANK YOU FOR SHARING
YOUR EXPERIENCE!

THANK YOU FOR RENTING THE TREKKER AND I HOPE TO SEE YOU AGAIN!